

The Edgecombe Group, Inc.

Frederick Douglass Memorial Gardens and Wetlands Conservancy

Clients

The National Park Service,
The Anacostia Garden Club

Location

Washington, D.C.

Point of Contact

Mrs. Diane Dale, *Manager*

Project Features:

- ▶ Wildlife Sanctuary
- ▶ Wetlands Demonstration
- ▶ Mini-Arboretum
- ▶ Greenhouse
- ▶ Public Plaza
- ▶ Native Plant Species
- ▶ Memorial Tree Grove

The Edgecombe Group, Inc.'s Role

- ▶ Urban Forestry
- ▶ Landscape Architecture
- ▶ Public Improvements
- ▶ Planning
- ▶ Public Participation

Completion Date:

2000 (Design)

Project Size:

40 Acres

Project Cost:

\$5 Million

Key Personnel:

Leland Edgecombe, ASLA
Principal-in-Charge
Senior Landscape Architect

The Frederick Douglass Gardens is a proposed floral and tree garden situated on a 40-acre site along the Potomac River. The site is located at the foot of the Frederick Douglass Memorial Bridge in the Anacostia Community of South East Washington, D.C. Functioning wetlands make up for eleven (11) acres of the site and would be featured in the overall design concept. This Project is proposed also to serve as a model wetlands reclamation demonstration project.

Design ideas for this mini-arboretum include footpaths, benches, various gardens with special collections, and a memorial tree grove. This design was intended to enhance the city's most aesthetic portal site while offering the local community the opportunity to enjoy the rich beauty of a functioning wetland.

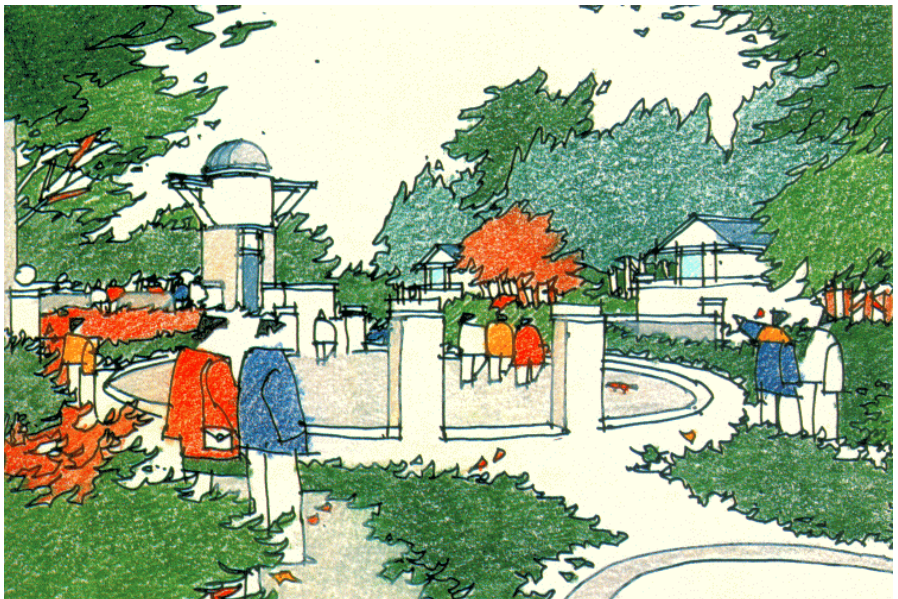

Illustration of a central gathering feature and memorial to ex-slave Frederick Douglass commemorating his contributions to American



View of the Potomac River's and the U.S. Navy Yard from the Arboretum



National Capital Planning Commission map of Heritage Site #2 for Frederick Douglass memorial arboretum

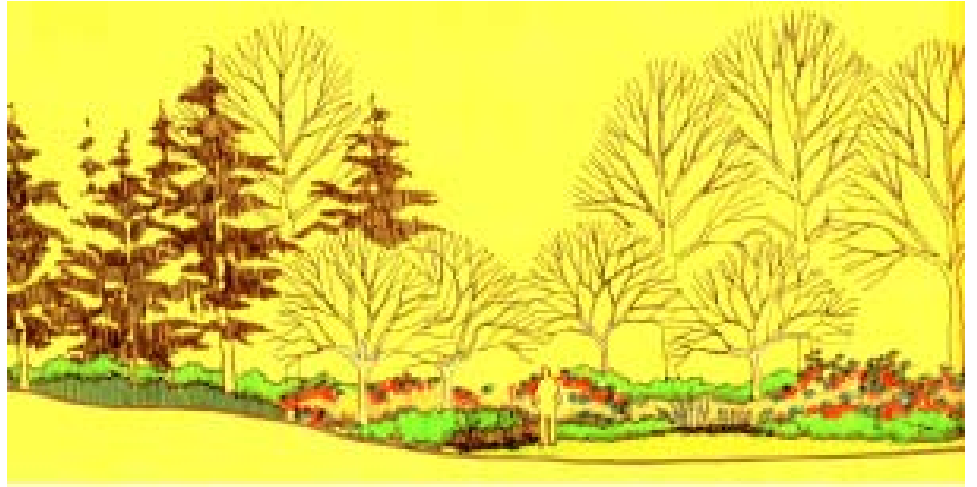

Site section of Arboretum revealing botanical varieties of the Mid-Atlantic



Map of Washington, D.C. showing memorial bridge connection to arboretum



Recommended treat and release programs for migrating birds



Existing Site to include 11 acres of Wetlands



Proposed Wetlands to include a variety of botanical gardens



Available open space for riverside recreational activities along the Potomac